



## Underfloor Air Terminal (Variable Volume)

MODEL:

**Élan - 06R - 180VAV - C**

### DESCRIPTION:

**Élan-06R-180VAV-C (Personal Displacement Diffuser)**

is a variable volume diffuser for use in raised floor air systems. The underfloor terminal features 20 gauge (1mm) galvanized steel construction, pre-painted flat black.

The air valve uses time modulation to vary total air supplied to a conditioned space. Air velocity is constant any time the valve is open; the short time duration between open/close cycles produces the effect of continuous air delivered to the occupied space. It is rated for 24V (18-30VAC) operation; one (1) PAP-1 Plug & Play Cable is included.

The nominal 6" (152mm) diameter cast aluminum grille is directionally adjustable, and produces 180 degree uni-directional displacement air flow. A manually adjustable sliding damper allows space occupants to limit maximum air flow. Ten (10) standard grille colors are available; custom colors and finishes can be provided to match architectural design (specify on order).

### FEATURES:

- DC synchronized magnetic motor
- Substantially horizontal displacement air flow
- Riveted pre-painted galvanized steel
- Redirect air flow by rotating grille
- Manual air flow adjustment with sliding damper plate
- Multi-function circuit board for varying control strategies

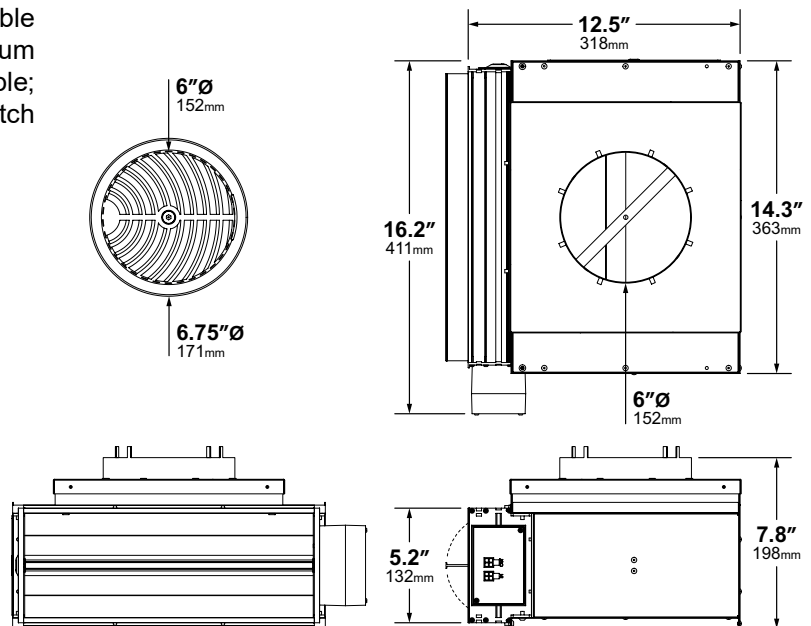

ALL DIMENSIONS NOMINAL +/- 0.1" (2.5mm)

### SPECIFICATIONS:

<b>Application:</b>	Underfloor Cooling   Raised Access Floors 6" (152mm) +
<b>Grille Dimensions:</b>	Diffuser Opening: 6"Ø (152mm)   Full Face: 6.75"Ø (171mm)
<b>Diameter (Nominal)</b>	Installation Cut-Out: 6.125"Ø [+1.125/-0.00] (156mm [+3.175/-0.00])
<b>Grille Rating:</b>	Cast Aluminum   Conforms to NFPA 90a   1250 lbs. (567 Kg) Load Strength
<b>Supply Press. / Temp.:</b>	0.02–0.1 in. w.c. (5–25 Pa)   40–140°F (4–60°C)
<b>Capacity:</b>	Maximum: 45 cfm @ 0.05 in. w.c. (77 m³/hr @ 12.5 Pa)
<b>(Nominal)</b>	Minimum (Damper Closed): 5 cfm @ 0.05 in. w.c. (8.5 m³/hr @ 12.5 Pa)
<b>Noise Criterion:</b>	≤ NC-17 (All Flow Conditions)